

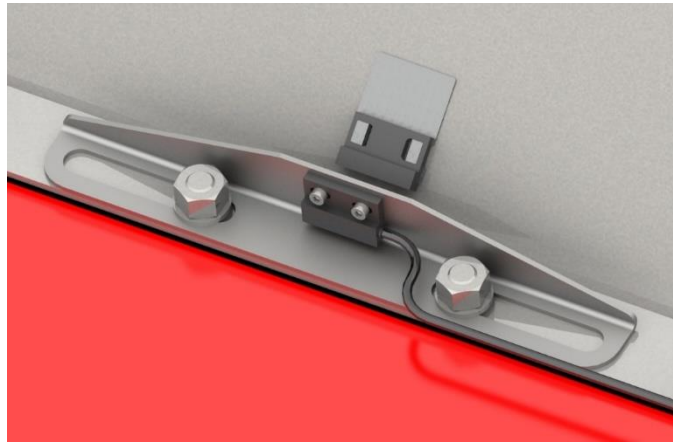

OPENING INDICATOR G2

VMP is an explosion venting device designed to protect explosion-proof technologies. Under normal operating conditions, the venting hole on the technology is covered by a VMP, which opens only when the opening pressure has been reached since the explosion. This will relieve the explosion into the surrounding area and reduce the pressure inside the protected technology below its pressure resistance.



This datasheet describes the VMP magnetic indicator.

The magnetic indicator consists of two parts called a magnetic sensor and a magnet. The magnet is attached to the VMP using the universal bracket (see below) and the sensor is attached with two M3x6 screws to the VMP frame or bracket. The magnetic sensor can sense the position of the magnet through the stainless steel sheet and can therefore be placed outside the stainless steel frame or stainless steel bracket. If the VMP is opened in an explosion, the magnetic sensor and the magnet move away from each other, the contact is broken and customer receives signal. An intrinsically safe circuit must be used as an interruption evaluation device. This means that the power supply to the position indicator must not exceed 10.6 V DC or 24 mA. An intrinsically safe relay forms the interface between the safe and hazardous zones. The position indicators can be connected in series.

CLASSIFICATION	
Operating temperature	-40 °C až 150 °C
Input voltage [max.]	10.6 V DC
Input current [max.]	24 mA

How to install the magnet on VMP:

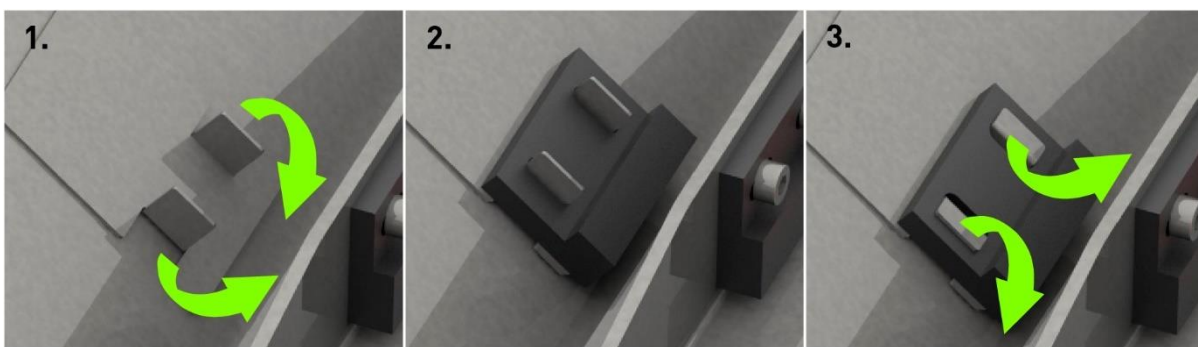

1. Use a suitable tool (flat screwdriver, pliers) to bend the position indicator plate metal strip.
2. Place the magnet on the position indicator plate as shown.
3. Bend the indicator plate metal strip back with a suitable tool.





Installation of magnetic sensor:

The installation depends on the VMP installation method, whether the top frame is flat or from L profiles.

Top frame flat:

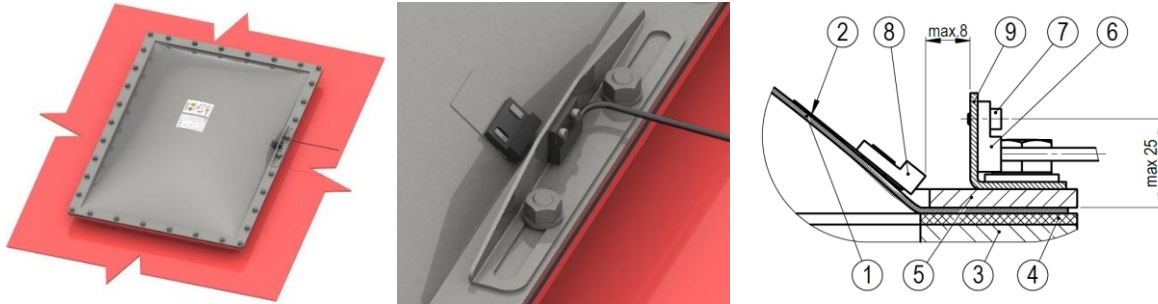

Top frame made of L profiles:



1. After installing the magnet on the VMP, it is necessary to mount the sensor on the upper frame using two screws pos. 7.
2. In order to install both parts (magnet and sensor) of the indicator, it is necessary to check the functionality with the measuring instrument.
3. The cable must also be connected to a suitable device (system) for signaling the opening of the VMP.

Position	Components
1	VMP
2	Position indicator plate
3	Protection equipment
4	Seal
5	Top frame (flat or made of L profiles)
6	Magnetic sensor
7	Screw M3x6 (ISO 4762) (2ks)
8	Magnet
9	Magnetic sensor holder ¹⁾

¹⁾ For flat VMP (type F) installation, one ISO 4070 washer must be used between the bracket and VMP for each bracket bolt (see user manual).